



52 Homeleaze Road, Bronby, Bristol, BS10 6BZ

£285,000

A perfect starter home or investment situated on the ever popular Homelease Road

- Opportunity to Improve
- No Onwards Chain
- Driveway for 2 Cars
- Generous Garden
- Convenient Location
- Peaceful Cul-de-Sac
- Two Double Bedrooms

### The Property

The property is nestled towards the end of a peaceful and quiet cul-de-sac, with views opposite featuring green woodland and the popular Filton golf club beyond. This semi-detached property provides a fantastic opportunity to develop and renovate into a stylish 2-bedroom home.

Entry to the property features an initial entrance hallway which leads on to the main reception room, towards the rear of the property is the kitchen with a back door opening out to the garden.

Upstairs on either side of the property are two double bedrooms with a generous family bathroom positioned in between them.

Outside, the garden has been decorated with patio slabs and benefits from a western orientation which pleasantly captures the afternoon/evening sun. Furthermore the driveway provides two off street parking spaces.

We believe this property presents the perfect opportunity for first-time buyers or a small family looking to shape a home to their desired taste.

### Location

Situated within close proximity of major employers such as Airbus, Southmead Hospital and Cribbs Causeway whilst providing excellent transport links via the M4/5. Nearby amenities include Westbury high street and Gloucester Road which host a variety of independent bars, cafes and restaurants.

### Further Information

Tenure - Freehold

Council Tax: B

### Please Note

Hollis Morgan endeavour to make our sales details clear, accurate and reliable in line with the Consumer Protection from Unfair Trading Regulations 2008 but they should not be relied on as statements or representations of fact and they do not constitute any part of an offer or contract. All Hollis Morgan references to planning, tenants, boundaries, potential development, tenure etc is to be superseded by the information provided in your solicitors enquiries. It should not be assumed that this property has all the necessary Planning, Building Regulation or other consents. Any services, appliances and heating system(s) listed may not been checked or tested and you should rely on your own investigations. The seller does not make any representation or give any warranty in relation to the property and we have no authority to do so on behalf of the seller. Please note that in some instances the photographs may have been taken using a wide angle lens.

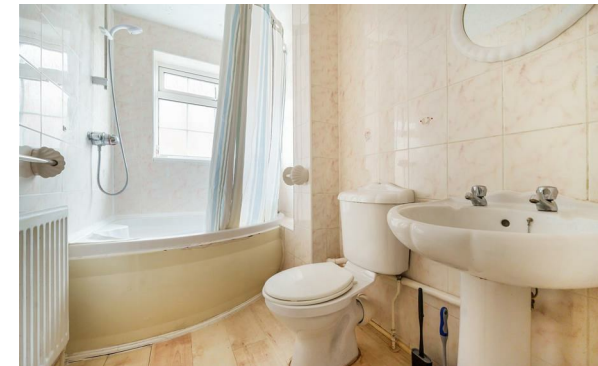

# Homeleaze Road, Bristol, BS10

Approximate Area = 628 sq ft / 58.3 sq m

For identification only - Not to scale

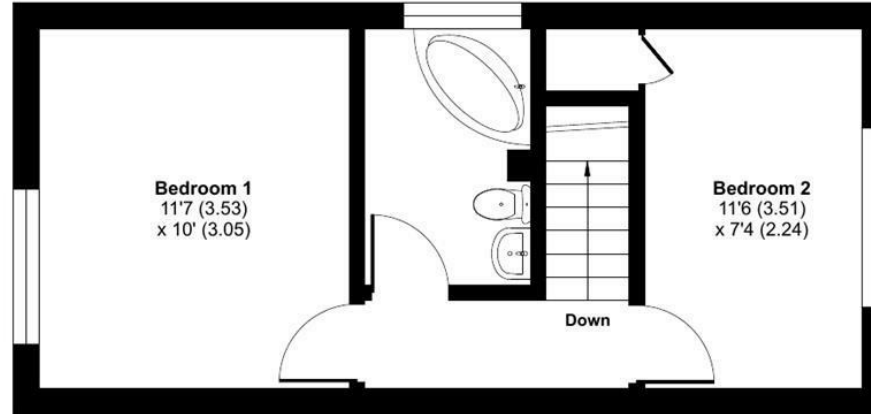

FIRST FLOOR

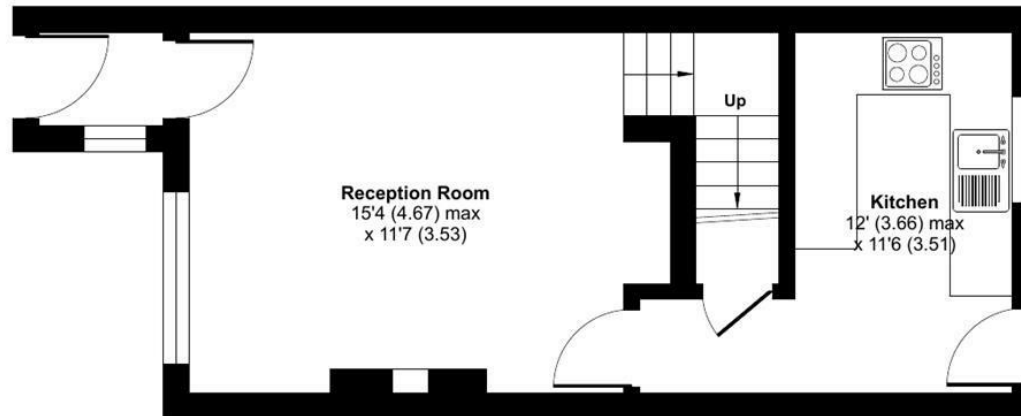

GROUND FLOOR



Floor plan produced in accordance with RICS Property Measurement Standards incorporating International Property Measurement Standards (IPMS2 Residential). © n̄cheom 2023. Produced for Hollis Morgan. REF: 1038877



TEL | 0117 933 9522 | 9 Waterloo Street, Clifton, Bristol BS8 4BT

[www.hollismorgan.co.uk](http://www.hollismorgan.co.uk) | [post@hollismorgan.co.uk](mailto:post@hollismorgan.co.uk)

Hollis Morgan Property Limited, registered in England, registered no 7275716  
Registered address, 5 Upper Belgrave Road, Clifton, Bristol BS8 2XQ

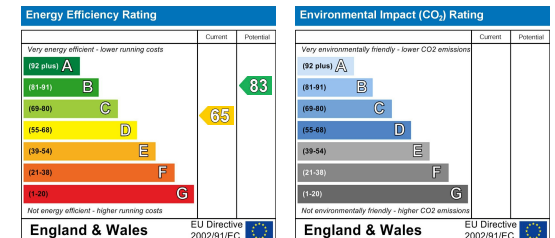

hollis  
morgan